

All Our Stories

The Art Strategy for the new Dumfries & Galloway Royal Infirmary

Client: NHS Dumfries & Galloway
Date: August 2015
Version: 05

WIDE OPEN



CONTENTS

Introduction	3	Project 16. Paediatrics artist in residence	18
Context	5	Supporting change	21
The building	5	Project 17 Paediatrics	21
The region and its peoples	6	Project 18. Staff project	21
Guiding Principles	7	The hospital as a hub	22
Evidence for the benefits of art in the healthcare environment	7	Project 19. Exhibitions	22
Commissioning strategy	7	Project 20. Performance	22
Projects	8	Transfer of existing artworks of historical significance	23
Wayfinding and Orientation	8	Project 21 . Relocation of Christie’s Well the accompanying stained glass and the photograph of the Well	23
Project 1. Designs for integrated screens, reception desks and signage	8	Project 22. Relocation of Sanctuary stained glass	23
Project 2. Artworks in corridors	10	Project 23. Tapestries	23
Project 3. Stories on the stairs	10	Gardens	24
Sensitive Spaces	11	Project 24. SANDS Garden	24
Project 4. Artist in residence	11	Project 25. Labyrinth	24
Project 5. Bereavement suites	12	Project 26. Landscape Engagement	25
Project 6. Palliative care corridor	13	Publication	26
Project 7. Oncology	14	Quality	27
Project 8. Interview rooms	15	Management and Delivery	27
Project 9. Sanctuary artworks	15	Committees	27
Staying and Waiting	16	Commissioning and contractual stages for artists	27
Project 10. Artist in residence	16	Costs & funding	27
Project 11. Waiting areas and sub waiting areas	16	Risks	28
Project 12. Baby feeding rooms	17	Timescale	28
Project 13. Ward waiting area at ward entrance	17	Evaluation	28
Project 13a. Ward Socialisation spaces	17	Maintenance	28
Project 14. Bedrooms adult, palliative care, paediatrics, neo-natal	17	Legacy	29
Project 15. Staff rest rooms	18	Research and Consultation	29
		Appendices	31

INTRODUCTION

“After nourishment, shelter and companionship, stories are the things we need most in the world.” Philip Pullman, writer.

Hospitals are redolent with stories – the stories we bring with us, the stories we tell in the hospital and the stories we take away with us when we leave. Stories help us to connect with each other and to reflect upon our experiences.

Through recognising that some of the very best things and the most difficult things in life occur in hospitals, this strategy details an ethos and a series of grounded projects which seek to enhance environments to support the range of experiences for staff, volunteers, patients and visitors in this state-of-the-art, thoughtfully designed new hospital for Dumfries & Galloway.

The commissioned artworks and therapeutic design elements and activities described in this Strategy to be delivered by Wide Open are proposed for both practical and aesthetic reasons offering enhancement of internal and external spaces. Each project is designed to create a calm, welcoming, reassuring and interesting building and gardens enhancing the building and inspired by the communities which it serves.

Reflecting the region through the art projects is paramount, especially the diverse natural environment for which Dumfries & Galloway is celebrated particularly as interpretations of the natural environment and familiar places is demonstrated as being of therapeutic value, supporting wellbeing and a sense of identity for all who work in, stay or visit hospitals. Thus an emphasis, except

for exceptional circumstances is placed on commissioning creative professionals living in or with close connections to Dumfries & Galloway. Wherever possible, meaningful engagement with groups across the region is embedded into project development and realisation.

The hospital is conceived as a hub which reflects and embraces all peoples of Dumfries & Galloway. As such, an aspiration to be tested as a pilot will be an innovative curatorial and events programme, offering appropriate exhibitions, performances and activities, generated through partnerships with regional arts organizations. Through this approach we aspire to the hospital being a place which supports wellbeing and healing in the widest sense of the word, a place to visit to enjoy a concert, an exhibition or a food fair.

SUMMARY

Hospitals are for and about people. The commissioned artworks and events programme reflects and supports the range of human experiences which occur in an acute hospital and draws upon the regions’ natural environment to do so.

Each commissioned element will recognise the specific requirements, constraints and opportunities which commissioning and making work for this new facility and its community necessitates. Works will be realised within the time scale that the new build schedule dictates, working closely with the Client, NHS Dumfries & Galloway and the High Wood Health led consortia.

Each approach described in the strategy is firmly grounded in detailed consultation with hospital staff, patients, stakeholders, volunteers members of the design team and with community groups across Dumfries & Galloway. This is contextualised by academic research, examples of best practice in arts commissioning and socially engaged practice in acute general hospitals and is contextualised by Wide Open's experience of over fifteen years of dedicated working in the field of therapeutic art and design in a wide range of healthcare contexts.

Wide Open would like to thank all the staff at DGRI, Stranraer Community Hospital and Langholm Community Hospital, volunteers, patients, community groups and representatives from Dumfries & Galloway's cultural and environmental institutions who have given their time and shared their expertise with such generosity, enthusiasm and insight to help with the creation of this strategy.

Jane McArthur, Creative Director, Health and Wellbeing,
Wide Open
May 2015

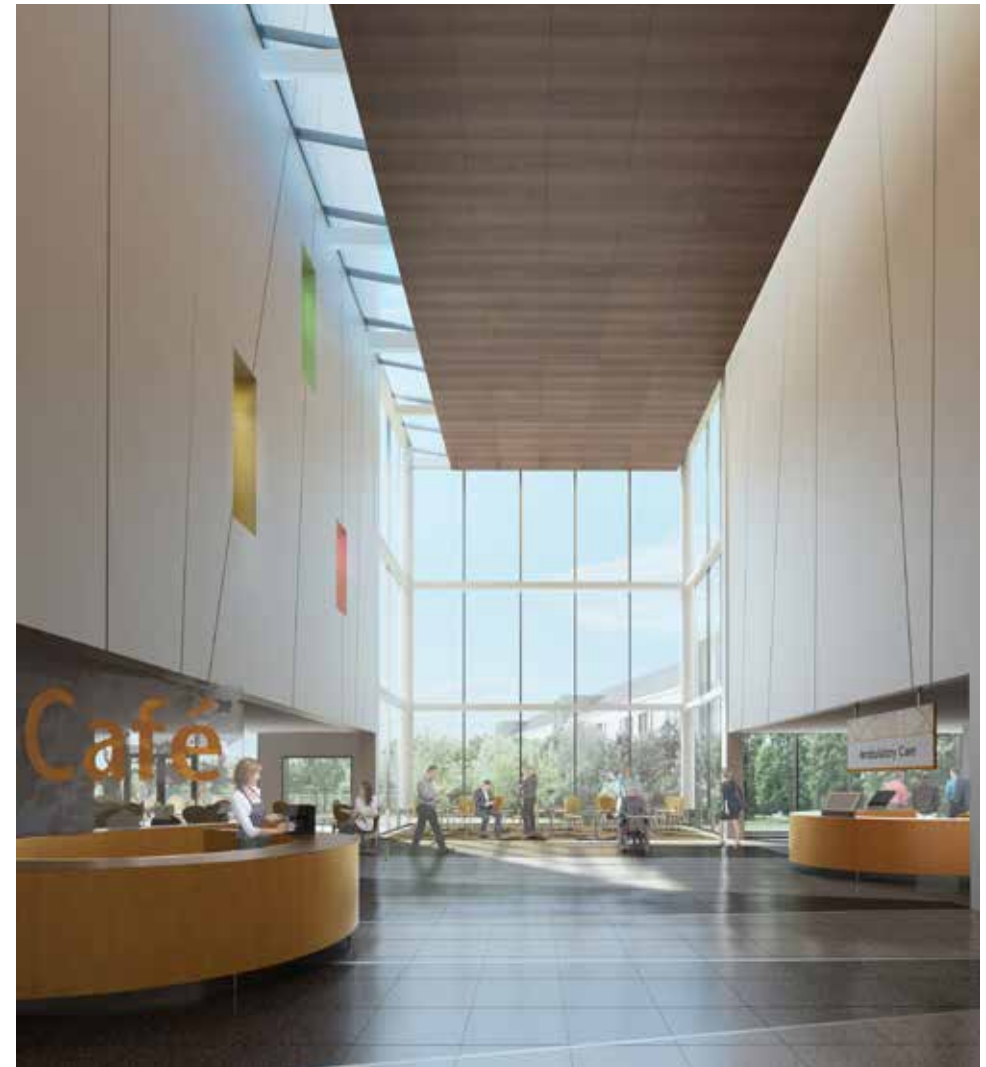

Design drawing, the new Dumfries & Galloway Royal Infirmary.
Image courtesy High Wood Health

CONTEXT

The building

The new hospital for Dumfries & Galloway is currently being built on a green field, forty-eight acre site at the A75 Garroch Roundabout on the western outskirts of Dumfries. It is a Non-Profit Distributing (NPD) build, costing in the region of £270 million and is due for completion in September 2017, to be open for patients in December 2017.

The hospital has been carefully designed to make the most of the extensive views from the site and will be situated in beautifully landscaped grounds.

The building is approximately 62,000 square metres with 340 beds. All eight wards comprise single bedrooms with en-suite bathrooms. The treatment areas include: Outpatients, Accident and Emergency, Combined Assessment, Women and Children, Oncology, Palliative Care, Theatres and Imaging.



Design drawing, the new Dumfries & Galloway Royal Infirmary. Image courtesy High Wood Health

The region and its peoples

“NHS in Scotland has a vision for an estate designed with a level of care and thought that conveys respect; buildings that grow from the local history and landscape, that are developed in partnership with the local community. A work of joint learning and joint responsibility that is particular to that community and that place; not off-the- shelf show boxes.” Dr Harry Burns, Chief Medical Officer NHS Scotland, 2009.

The hospital serves a population which is centred around two major towns – Dumfries and Stranraer, smaller rural towns and a widespread and in certain areas scattered population who do not travel to Dumfries except to attend the hospital. The travel time to the hospital can be up to two hours for those living in the far east or west of the region. Dumfries & Galloway has a higher than average older adult population whose numbers in proportion to the rest of the regional population is expected to increase over the next twenty years.



Left: Riding of the Marches, Annan. Right: Alice Francis, 'Couch', Spring Fling, 2012, near Gelston

Guiding principles

The commissioning process will be governed by the following aims and objectives.

To:

- Convey a sense of quality health care through the integration of considered arts projects into the built and landscaped environment.
- Employ the therapeutic value of arts to provide a caring, sympathetic and supportive atmosphere for patients, visitors and staff.
- Enhance spaces to create welcoming, safe, interesting areas, thus improving communication and consultation outcomes.
- Offer opportunities for positive distraction and points of recognition which reflect regional identity.
- Support orientation and wayfinding.
- Ensure connectivity between areas of the hospital and between the identified projects and project strands.
- Ensure that permanent works are suitable and durable for the environment in which they are installed and meet health and safety and infection control requirements.
- Ensure that all elements are delivered in the time line agreed with and in close consultation with High Wood Health and NHS Dumfries & Galloway.
- To build on existing close community links with the hospital and develop
- new and meaningful partnerships with the region's arts and environmental organizations.
- Ensure excellence from concept, community engagement to the realisation of final works.
- To share learning experiences with healthcare and creative communities.

Evidence for the benefits of art in the healthcare environment

There is a significant body of careful UK and International research which has been undertaken over the last forty years, demonstrating the positive impact of art and design in the healthcare environment for staff, patients and carers. In particular, building upon Roger S Ulrich's ground breaking experiment in the 1970s, there is forceful scientific and empirical data demonstrating the benefits of images of or access to gardens and the natural environment in the healthcare setting.

Relevant case studies are sited throughout the strategy as examples of best practice and as a rationale for proposed projects and activities.

Commissioning strategy

Artists will be commissioned through competitive interview, unless they have a skill which is unique in the region.

Briefs and contracts will be agreed by NHS Dumfries & Galloway and where relevant High Wood Health. Where agreed with High Wood Health, artists will be required to work with the contracted designers.

The artworks and therapeutic design solutions will be commissioned through three main residencies, with other professional creative practitioners appointed to fulfil specific briefs. It is proposed that for certain areas pieces are also purchased directly from professional local artists.

Please see Table 1 which identifies the proposed tasks for each artist.

PROJECTS

“Where time and attention has been tailored to meet patient needs, the resulting environments have had ‘therapeutic impact’. These environments, which encourage patients to feel looked after and cared for, and for staff to feel valued, demonstrate that public art projects have an impact beyond the physical environment.”

Evaluation of the King’s Fund’s ‘Enhancing the Healing Environment Programme.’ NHS Estates, 2003.

Twenty-six projects are proposed which will result in design enhancement and artworks throughout the hospital and in the gardens. Delivered under Wide Open’s curatorial umbrella, there will be a connectivity and coherency between all the projects whilst ensuring that there is where appropriate department identity. Public spaces such as corridors and the dining area, the semi private such as socialisation wards and sub-waiting areas and the private spaces to include ward bedrooms, bereavement facilities and interview rooms have all been given equal consideration as have the different needs of staff, patients, visitors and volunteers. The projects are encompassed within seven delivery strands;

- Wayfinding and orientation;
- Sensitive spaces;
- Staying and waiting;
- Supporting change;
- The hospital as a hub;
- Transfer of existing artworks of historic significance;
- Gardens.

WAYFINDING AND ORIENTATION

Keywords: welcome, support wayfinding, integrated, reflect the region, gentle visual interest.

Project 1. Designs for integrated screens, reception desks and signage

An artist will be commissioned to research and deliver botanically themed designs which reflect the flora of the region in order to create a distinct visual identity for each area of the hospital so as to support wayfinding.

The commissioned artist will design for the following elements:

Five designs as vinyl manifestations for 22 screens to clearly identify cafe and treatment areas on the ground floor. They will be graphically strong, distinctly recognisable and designed to replicate etched glass.



Design drawing, the new Dumfries & Galloway Royal Infirmary.
Image courtesy High Wood Health

Elements from these same designs will be extracted and possibly simplified for the reception desks where a colour will be added. This same graphic element will be incorporated into the signage, so that the visual language for each area on the ground floor corresponds between screens, desks and signage.

Further designs will be developed for the reception desks and corresponding design for the signage for each other area of the hospital.

The designs for the reception desks are to offer a focal point and a sense of welcome without being distracting for people approaching the desk. The same design to be incorporated for the signage will be easily recognisable DDA compliant and will not distract from the text, but rather offer another means of wayfinding particularly appropriate for people with learning disabilities and visual impairment.

The designs will be created by the artist to the technical specifications provided by High Wood Health and will be delivered to High Wood Health in an appropriate electronic format for manufacture and installation by High Wood Health. The time scale for completion of the designs will be advised by High Wood Health.

It has been requested that TAG (Dumfries & Galloway Advisory Group for people with learning disabilities) and the DGRI volunteers could be consulted regarding wayfinding.

Commissioning process: An artist will be commissioned following competitive interview.

Dalziel & Scullion, Primary health and care centre, Alexandria
Alison Unsworth, new South Glasgow Hospital



Project 2. Artworks in corridors

“Yes, I think it is marvellous, you walk down the corridors and see all the pictures and you feel resuscitated having spent a morning in a busy clinic and that is extremely important...”

Senior Clinician, *Designing for Health*, Durham University, 2007.

Artworks in the corridors are designed to offer gentle positive distraction, and support exercise and discovery for patients.

Working with hospital staff, Wide Open will support the selection of artworks from the existing hospital collection for installation in corresponding areas in the new hospital on appropriate corridor walls agreed with High Wood Health. New works by local artists will also be purchased reflecting the ‘all our stories’ theme. This is designed to facilitate secondary wayfinding and offer positive distraction. The weight of all works will be within the weight tolerances advised by High Wood Health.

Commissioning: Wide Open will work with a small hospital staff working group to select current artworks and purchase new artworks with a small hospital staff working group.

Project 3. Stories on the stairs

This project is designed to reflect the region as a whole in the new building. It is proposed that a poet/writer will make eight different walks in seven different locations across the region with eight different local groups. This could include the Multi Cultural Association, U3A, pupils from a primary school, and local walking groups. The poet will write a series of ‘stories’ which will be designed



Use of imagistic text in the hospital context. Lucy Richards, Royal Aberdeen Children's Hospital.

as text manifestations by Lucy Richards, working for High Wood Health and working in close collaboration with the commissioned poet/writer.

It is proposed that the stories are installed on the walls of seven sets of staircases to encourage use of the stairs by staff, patients who are able and visitors to the hospital. Each text will tell a different story understandable from any entry point on each staircase and in either direction of travel. The text layout will be visual and reflect the nature of the story told. A story in the paediatrics lift is also required.

The staircase from neonatal requires particular and sensitive consideration as this is the exit which may be used by parents who have experienced a bereavement. Consultation with the Sensitive Spaces artist in residence is advised.

It is proposed that this project is delivered in consultation with the Health and Wellbeing team NHS Dumfries & Galloway and in partnership with the Wigtown Book Festival which may also result in a reading at the Festival.

Commissioning process: A poet/writer will be commissioned following competitive interview. They will work with designer Lucy Richards for the visualisation of the text.

SUMMARY

Wayfinding and Orientation comprises three projects.

- Botanically inspired graphic works as manifestations on screens, integrated desk panels and signage.
- Relocation of existing artworks and purchase of new works for corridors which tell a story of the region
- Stories on the Stairs – text as designed vinyl manifestation inspired by walks with different groups across the region to be installed on staircases to encourage use of stairs.

SENSITIVE SPACES

Keywords: consultation, grounded research, emotional intelligence, safe, caring, gentle, holding, less clinical in feel.

Project 4. Artist in residence

A six-month research-led programme developed jointly between Wide Open and Ewan Kelly, Spiritual Care Lead NHS Dumfries and Galloway is proposed in order to explore issues concerning death and remembrance with hospital staff, and the wider community. This will be a sensitively and carefully designed project which will inform the work for areas in the hospital identified as 'sensitive spaces' as well as feed into aspects of the work undertaken by the Spiritual

Care team in preparation for how the new Sanctuary may be used in the new hospital. Importantly, this project will support understanding amongst staff and volunteers of how the new Sanctuary can be used to support all who attend or work in the hospital.

This piece of work will inform the commissioning of art and design elements for bereavement suites, palliative care, oncology and the Sanctuary.

Commissioning process. It is anticipated that an artist selected following a competitive interview will lead on the work for these areas, but other creative professionals may be commissioned to produce specific elements.

Project 5. Bereavement suites

It is proposed that the artist works with Anne Westgarth, Laboratory Manager Microbiology, Pathology and Mortuary, NHS Dumfries & Galloway.

The new hospital will have three bereavement areas.

It is proposed that colours, flooring and uplift for furniture are carefully considered by working in collaboration with the design team and staff for each of the three areas, to create a supportive environment which also works in harmony with the existing artworks.

The Mortuary: Artworks have been recently commissioned from local artists which are currently installed in the existing mortuary bereavement facilities. These will be re-installed in the relatives room, the interview room and the viewing room in the new hospital. The artworks are:

- 'Swifts', by Lizzie Farey, made from treated willow.
- Woven textiles by Alison Fair working with the Loch Arthur Community weavers.

"It is important to remember that this is a place where people say goodbye."
Sally Votier, Senior Charge nurse, A&E.

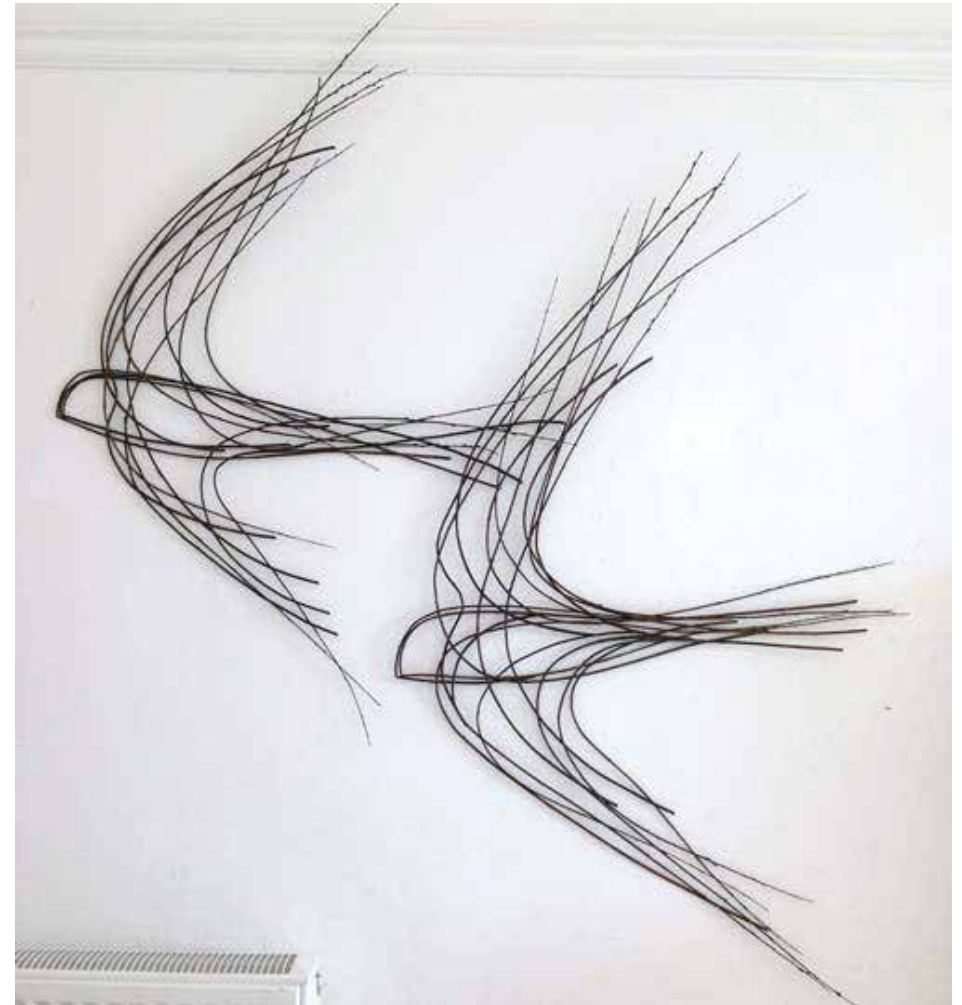

Lizzie Farey, 'Swifts', commissioned for the current mortuary bereavement facilities.

- Framed paintings by Silvana McLean.

It is intended that a lightbox displaying an appropriate artwork is created for the waiting room to counteract the lack of natural light or access to the gardens.

Combined Assessment Unit: Consultation with nursing staff revealed that the bereavement facilities need to feel and look different from other places in the hospital so that there is as little association as possible for those who have suffered a bereavement in A&E/CAU which can be a traumatising and shocking experience, if they attend other areas of the hospital on other occasions.

Staff working in this area are keen to facilitate conversations with families who have experienced a bereavement in A&E as they feel it is paramount to involve relatives in the work for this area so that the appointed artist gains insight into what these particular spaces need to do. Again, it is proposed that colours, flooring and furniture are carefully considered by working in collaboration with the design team to create a supportive and safe feeling environment.

Birth Suite: This is an area requiring sensitive consideration. Thus it is proposed that the artist works with SANDS as well as with neonatal staff and in collaboration with the design team to create a supportive and safe feeling environment.

Project 6. Palliative care corridor

This is a long corridor for relatives to walk along to make what could be a difficult journey either to the palliative care ward or away from the ward for the last time. Although there are windows along one side of the corridor offering views into the garden, it is proposed that carefully considered artworks as gentle

CASE STUDY - BEREAVEMENT FACILITIES

“We remember so clearly those last things... it makes a huge impact, those last impressions, they feature in your dreams. It's not just the parents but the brothers and sisters too. It has to be nice, not frightening.”

Bereavement Suite user, Birmingham Children's Hospital. 'Improving Environments for Care at the End of Life', Kings Fund, 2008.

A complete refurbishment of the Christie Hospital's, Manchester, bereavement facilities has transformed the experience of carers and relatives wishing to view the body of their loved one.

As a result there has been a significant increase in the number of visits with relatives and carers reporting they feel more comfortable because of the relaxed surroundings.

The project has highlighted how an appropriate environment contributes to the overall experience for bereaved visitors. As a result all future capital projects throughout the organisation have been instructed to incorporate artwork.

distraction which relate to the views through the windows are commissioned to support these journeys. They will also be welcomed by staff using the corridor. Lightboxes to create a sense of soft light and the natural world are agreed for this area.

Project 7. Oncology

Following consultation with staff and patients, it is proposed that this whole area is understood as a sensitive space where patients need to feel safe and nurtured. It is proposed that element relating to the region's natural environment are the concept for this area, particularly as the waiting areas and the quiet rooms have no natural daylight.

Identified areas are:

- **Threshold:** It is recognised by staff that entering the Oncology unit for the first time is difficult for patients. With this in mind staff have requested that attention be paid to this threshold. It is proposed that a delicate vinyl manifestation be designed for the large window looking into the Information Lounge. It should be an open design so that people can still see into the room, but will help to offer a sense of welcome whilst softening this entry point.
- **Corridors:** Artworks from the existing collection as orientation markers are proposed. Artworks for the consultation/examination room corridor will need to be carefully selected by the artist making the artwork for the lightbox so that there is harmony between them. Artworks are also proposed for key walls within the unit.

Above: Artworks commissioned for the new South Glasgow Hospital..

Below: Rowena Dring, Think of Paradise, Barts Breastcare Centre,



An artwork will be commissioned for a lightbox which is to be installed at the end of the windowless corridor. This will ensure that all who use the corridor will be walking towards an uplifting and beautiful light-emitting artwork which takes as its theme the natural environment. The commissioned artist will consult with Oncology staff and where appropriate with patients.

- Consultation/Examination rooms: It has been requested that although these are clinical spaces, there is an element which brings colour and humanity into these rooms. The artwork/design element will be identified with staff and patients during the residency.
- Interview rooms, quiet rooms, waiting areas, the appliance room, the therapy room and the Information Lounge are to be considered in terms of colours, flooring, furniture and artwork where appropriate. A manifestation is required on the treatment room window to screen the view from the services yard below.
- The Treatment Bay requires sensitive consideration to ensure that it is both a peaceful and calm space which offers points of gentle distraction for patients receiving treatment. As patients will be seated looking towards the patio, it is proposed that there are plants for seasonal interest on the patio.

Project 8. Interview rooms

It is proposed that colour, flooring, uplift for furniture and an artwork are carefully considered by working in collaboration with the design team and staff for these spaces throughout the hospital.

Project 9. Sanctuary artworks

Pieces commissioned from local makers are proposed. This could include a moveable screen to offer privacy in the side rooms and a projected labyrinth designed for the space to be used as therapeutic support. Elements will be identified with Ewan Kelly and his team during the residency.

Commissioning process: Artists will be commissioned following competitive interview, and by invitation for the Sanctuary artworks. See Table 1 for breakdown of tasks in relation to commissions.

SUMMARY

An artist in residency working with the Spiritual Care team will lead this project to research the creative principles for:

- Bereavement Suites
- Oncology
- Interview rooms
- Palliative Care Corridor
- Sanctuary

This project will involve working with other artists commissioned for specific elements, but with an overall strategy developed through the research this will bring a strong and grounded creative rationale and cohesion to each of these areas.

STAYING AND WAITING

Keywords: interesting, calming, easily identifiable, welcoming.

“Corridors and waiting areas are some of the most stressful places in hospitals. Positive distractions are key to the patient journey”.

Dr Janet Gardner, Yorkhill Children’s Hospital

Project 10. Artist in residence

This proposed project grew from a meeting between Penny Halliday (Dementia Champion and NHS Board member) and Gladys Haining (Lead for NHS Board for Dementia and Acute Care). It is inspired by the aspiration to ensure that voices and experiences across age groups and social backgrounds from the whole region are reflected in the new DGRI, a particular emphasis being placed upon working with older members of the population, especially those living with or caring for someone with dementia. It is imperative that the needs of our elderly population are considered throughout the new hospital.

It is therefore proposed that an artist is commissioned to undertake three short residencies one in a community hospital in the west of the region, one in the east and one in the existing DGRI respectively. They will be contracted to research through community and staff engagement the enhancement of areas listed in the strategy for the new DGRI. As part of this work, they will also deliver enhancement for an agreed area in each of the two community hospitals.

iAlexandre Robb, ‘Snow, Auldgirith’, DGRI collection

Project 11. Waiting areas and sub waiting areas

All outpatient waiting areas will be defined either by a screen carrying a botanical graphic manifestation or a desk displaying a coloured botanical graphic manifestation. Where there is neither, it is proposed that an artwork from NHS Dumfries & Galloway’s collection or a work from a local artist will be purchased.

Play areas in waiting rooms excluding paediatrics are proposed to be defined by floor and wall colours which demarcate this designated area from the rest of the waiting room, ensuring that it looks attractive and enticing for children. Particularly important is the play area for dental outpatients as this is where the majority of children attend as patients.



Project 12. Baby feeding rooms

These spaces can be neglected in public buildings. It is therefore proposed that consideration of colour flooring and furniture is undertaken and an appropriate artwork is purchased to offer gentle interest.

Project 13. Ward waiting area at ward entrance.

It is proposed that artist's print are purchased from local artists whose work is graphically strong with an obvious identity which will create a memorable wayfinding marker for each ward as well as a sense of welcome.

Project 13a. Ward socialisation spaces

Particular attention is required for the ward socialisation spaces in terms of furniture uplift, colour and artwork to create an inviting area attractive for patients to spend time in. This is particularly important for older patients who may feel isolated in their rooms.

Project 14. Bedrooms adult, palliative care, paediatrics, neonatal

It is proposed that four designs are commissioned to be printed onto wallpaper appropriate for healthcare bedrooms. This will create a feature wall in each bedroom offering interest and also soften the clinical feel. The design will be integral to the colour strategy and furniture uplift, where required, for these spaces.

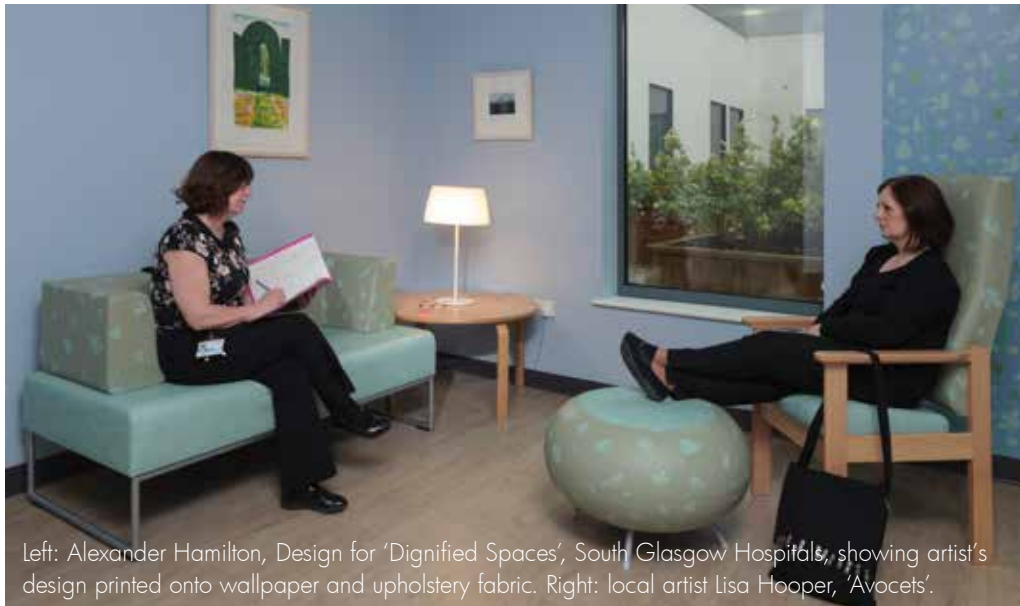

Left: Alexander Hamilton, Design for 'Dignified Spaces', South Glasgow Hospitals, showing artist's design printed onto wallpaper and upholstery fabric. Right: local artist Lisa Hooper, 'Avocets'.



Project 15. Staff rest rooms

It is proposed that artworks from the existing collection are selected for installation in the three rest rooms, one in the Emergency Care Centre and two in theatre.

Commissioning process: Artists will be commissioned following competitive interview. See Table 2 for breakdown of tasks in relation to commissions. Where indicated, working with a small hospital staff working group Wide Open will facilitate the selection of current artworks and the purchase new artworks.

Project 16. Paediatrics artist in residence

It is proposed that an experienced artist is commissioned to undertake a residency in Paediatrics at the current hospital. This will enable the development of grounded proposals for artworks appropriate for children and for young people which offer interest, distraction and exploration. Areas for particular consideration are: the corridor, waiting rooms, dining room, and the young adult's space.

The artist will need to be aware of the University of the West of Scotland's Schools Enterprise Challenge which will result in proposals for paediatrics. It is also proposed that the artist devise a celebratory board of achievements to help overcome fears.

A partnership project with the Peter Pan Moat Brae Trust is proposed to deliver the following:

- A writer in residence both in the hospital and with Moat Brae in the region to help to create a strong working partnership between the hospital and



Designs printed onto curtains and furniture at the London Royal Children's Hospital

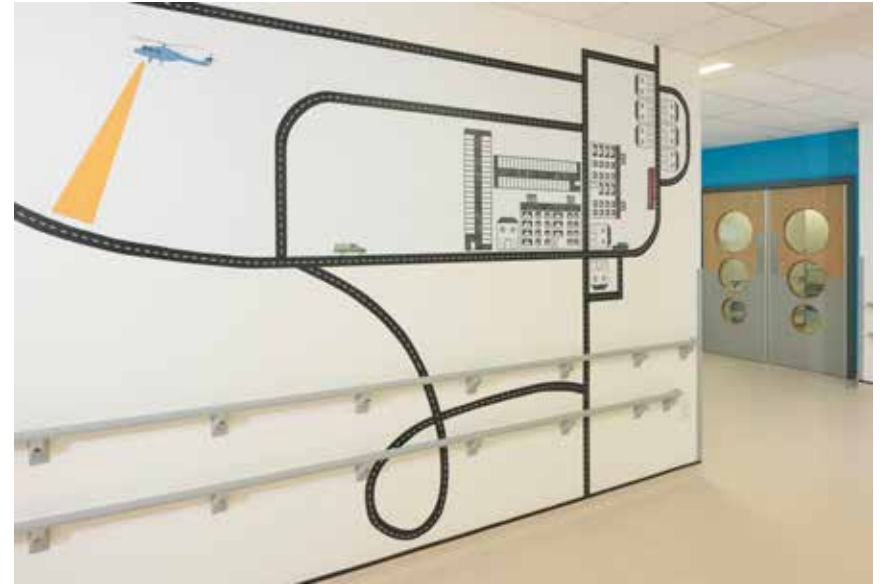

Artworks for the new South Glasgow Children's Hospital, except for bottom left: Chill out room, Teenage Cancer Hospital, Cardiff, and top middle: London Royal Children's Hospital.

Moat Brae for continued activities.

- A 'book at bedtime' volunteer programme for reading stories to children and also recording stories to make up a digital library to be used both at Moat Brae and in the hospital. This would be in partnership with the Library Services and potentially with the Electric Theatre Workshop.

The artist will deliver a workshop with Art and design students at Dumfries & Galloway college who will use the new hospital as a live model for their public art module.

Commissioning process: Artist appointed following competitive interview.

SUMMARY

Artworks and therapeutic design enhancements are proposed for:

- Waiting and sub-waiting areas – art from the collection or purchased.
- Baby feeding rooms, colour, uplift to furniture, artwork from the collection or purchased.
- Ward Socialisation spaces, uplift to furniture, artwork from the collection or purchased.
- Staff rest rooms: installation of artworks from the existing collection
- Outpatient's lounge, day treatment, uplift to furniture, artwork from the collection or purchased.
- Wallpaper designs x 4 for a small feature wall in bedrooms for adult, palliative care, paediatrics, neonatal respectively.
- Paediatrics residency to include artwork and therapeutic design solutions, development of volunteer programme and supporting change.

CASE STUDY - ART AS DISTRACTION FOR CHILDREN AND YOUNG PEOPLE, ROYAL ABERDEEN CHILDREN'S HOSPITAL

"Make it child focused without being patronizing ... make it inviting and playful" Parent and workshop participant.

'A boy and his mother open the door to an X-ray room where jungle creepers and tropical leaves wind their way around the room and pink lizards scurry across the ceiling. "Cool" he says as he stands and stares, forgetting the purpose of his visit in his excitement to see more. The plants and animals that fill the room are an artist's colourful vision of a distant place, far removed from the clinical environment normally found in the X-ray suite of a hospital. But the illusion is complete and the jungle becomes reality for the duration of the treatment as the boy lies and watches a parade of exotic animals and reptiles slowly dancing across the ceiling.'

"The positive effects of contemporary and colourful art have been felt by staff, children and families ... Particularly in our treatment rooms the illuminated art provides a focus for children undergoing procedures and always becomes a talking point and a point of distraction." Caroline Pirie, Surgical Ward Sister.

Anne Moore et al, (2009) 'Artworks, Royal Aberdeen Children's Hospital, 2006 – 2009', Royal Aberdeen Children's Hospital.

SUPPORTING CHANGE

Keywords: ritual, marking, process, learning, celebrating, continuing the story.

Project 17 Paediatrics

Making a time capsule has been identified during consultation as a means by which patients, families and staff can be supported in the process of change from the current hospital to the new. This is particularly important for patients and their families who have a long connection with the current building. The artist in residence in paediatrics will deliver this project.

Commissioning process: This element will be incorporated into the brief for the artist's residency in paediatrics.

Project 18. Staff project

During consultation with staff it became apparent that there was a particular need to mark both the physical and emotional change which staff will experience during and following the move from the current hospital to the new building. Inspired by staff in A&E, it is proposed that a project is developed specifically for staff. Photographing the old and the new has been requested by A&E staff. It is proposed that they work with an artist to shape the project and develop their creative skills.

Commissioning process: An artist working with photography will be commissioned following competitive interview to deliver this project and the works for the lightboxes for Oncology and the Mortuary respectively.

SUMMARY

Proposed projects to support and mark the change from the old to the new hospital for staff, volunteers, patients and visitors.



Shauna McMullan, Inscrubables. Supporting the process of change. Gathering memories from staff about the old Royal Infirmary Edinburgh which were inscribed onto panels in the new building.

THE HOSPITAL AS A HUB

Keywords: vibrant, changing, reflecting region's talents.

It is proposed that the new hospital truly reflects the whole community and as such becomes a place which reflects the talents and interests of the people of Dumfries & Galloway. Through a series of partnerships developed through a funded pilot project, it is proposed that the hospital plays host to a range of cultural events and activities.

Project 19. Exhibitions

The exhibition space in the existing hospital which shows the work of local artists is popular with staff who enjoy the variety of works that changing exhibitions bring, when the space is active. Programming this space as is the case with every healthcare building without an arts co-ordinator, is problematic. To avoid blank walls when nothing is being exhibited, it is proposed that bespoke exhibition stands are commissioned which can be erected in the main atrium when there is an exhibition, but which will not remain in sight and empty when nothing is programmed. It is anticipated that schools, the college, regional art societies and the region's artists would be able to use this space with the hospital taking a commission from works sold.

As part of this work, it is proposed that Wide Open develops a donations policy which can be used when donations of artworks are offered. An exhibitions policy will also be written with exhibition information and a standard letter of agreement to be signed by exhibitors.

It is proposed that Wide Open work with a small group of volunteers to curate this space. This project should begin in the current hospital so as to ensure that there is already an active volunteer run programme with connections made and curatorial skills gained when the hospital moves and Wide Open is no longer contracted.

Project 20. Performance

Dumfries & Galloway Arts Festival is seeking to develop a programme of cultural events throughout the year, rather than purely focusing on an annual two-week festival in May. It is proposed therefore that a pilot of suitable cultural events involving both professionals and community groups be programmed to take place in the new hospital and grounds. It is anticipated that appropriate small scale 'taster' events could be programmed for the existing hospital, possibly in oncology and the lecture theatre in the evenings or solo/duet performances in the atrium to begin to build experience and relationships before the move to the new location.

It is anticipated that this partnership could involve a commissioned performance which tells the story of the history of hospitals in the region, marking and celebrating the move from the old to the new DGRI.

Partnership: Dumfries & Galloway Arts Festival.

Commissioning process: Not applicable at this stage.

SUMMARY

A programme of activities and exhibitions which reflect the talent and interests of people living and working in the region.

TRANSFER OF EXISTING ARTWORKS OF HISTORICAL SIGNIFICANCE

Keywords: supporting change, reflecting and continuing historical associations

Project 21. Relocation of Christie's Well the accompanying stained glass and the photograph of the Well.

The Well is to be located in the first courtyard in Ambulatory Care with the stained glass in lightboxes and the photograph located on the adjoining corridor wall.

Project 22. Relocation of Sanctuary stained glass

The five panels in the current Sanctuary are to be relocated to an appropriate corridor space within the hospital to agreed with Ewan Kelly and the design team. These will need to be displayed in lightboxes.

Project 23. Tapestries

Although there is a strong desire to move the tapestries on display in the current hospital to the new building, it is understood that they are simply too large to be installed. Alternatives will be sought in other healthcare buildings in Dumfries in recognition of their unique and special status in the history of the hospital.

Commissioning process: Not applicable

SUMMARY

Transfer of existing important artworks from the current hospital to the new building.



Above: Christie's Well Below: Community Choir, St Christopher's Hospice.

GARDENS

Keywords: to encourage people to go outside, interesting, beautiful, supportive, therapeutic, enticing, easily maintained, for all ages.

Project 24. SANDS Garden

Following consultation with SANDS D&G and neonatal staff, it is proposed that a garden be created which can offer succor for parents who have experienced the death of a baby at whatever point in their bereavement. The garden will also be a calm, peaceful, safe and supportive place for all patients, visitors and staff to use.

The triangle of land opposite the front of the hospital which is close to the main car park and to maternity services, can be seen from the windows of this part of the hospital and does not necessitate entering the hospital building to access the garden is proposed.

The garden will also be a beautiful, peaceful and contemplative space for all to use, but will have special meaning for bereaved parents.

It is proposed that paths meander through the garden, with planting creating secluded areas each with a seat, that people can discover and which they can feel is their special place to return to. Planting should also shield the garden from traffic noise. There should be something to look at – planting, a tree, text on the seating, which can offer gentle distraction should this be required, but that is not intrusive.

It is proposed that SANDS, supported by Wide Open will undertake initial work

with Fira to understand in more detail the landscape design for the proposed area of the hospital grounds. Within the agreed designated framework of the landscape design, additional elements can then be devised depending on ambition and funding availability. This method of working ensures that the design agreed as part of the contract delivered by High Wood Health can be implemented without any danger of delay.

It is proposed that a skilled and sensitive creative professional (artist and/or garden designer) be commissioned to work to an agreed brief with SANDS to research and identify the additional elements for the garden. This work will ideally necessitate consultation with SANDS members across the whole of D&G. Wide Open will manage the creative professional, their briefs and contracts in consultation with SANDS and with the design team.

Commissioning process: A garden designer will be commissioned following competitive interview.

Project 25. Labyrinth

Following discussion with NHS Design Team and Ewan Kelly, it is proposed that local labyrinth artist Jim Buchanan design and build a labyrinth which is low maintenance whilst preserving an element of natural planting.

The labyrinth would be designed for use by staff, patients and visitors of all ages and levels of mobility, either in organized and facilitated groups or through their own discovery. It will be located in an easily accessible location for patient groups, visitors and staff.

The labyrinth will be designed to the specifications of an agreed site using

materials appropriate for the healthcare context and garden maintenance schedules. Seating at the edge of the labyrinth will be an integrated component of the design. The design will compliment the proposed projected labyrinth commissioned for the Sanctuary.

It is proposed that the labyrinth motif is carved onto the seating so that people unable or not wishing to walk the labyrinth may trace it with their fingers.

The artist will undertake research and development with appropriate patient and carer/family groups.

Once the labyrinth is built, it is proposed that working with Ewan, Jim trains staff and volunteers to work with other staff as well as patients and where appropriate families to use the labyrinth for health and wellbeing benefit.

Commissioning process: Jim Buchanan will be commissioned as he is the only professional in the region with this skill.

Project 26. Landscape Engagement

A series of temporary creative events engaging with communities across the region are proposed in partnership with The Stove, Forestry Commission Scotland, The Biosphere and Scottish Natural Heritage to enable community groups to explore elements of their natural heritage. These 'stories' will be inform the development of the green spaces at the further reaches of the hospital grounds.

Commissioning process: To be determined with partners and NHS Dumfries & Galloway.

SUMMARY

- Outside spaces designed to encourage the hospital community to enjoy the gardens for therapeutic benefit, exercise and play.
- SANDS garden
- Labyrinth for therapeutic means, exercise and play
- Wider Landscape project which reflects the wilder elements of the region to be created post hand-over.



Local artist Jim Buchanan marking out a temporary labyrinth at Sandyhills

CASE STUDIES - THERAPEUTIC BENEFITS OF LABYRINTHS

The Labyrinth Society lists forty-five papers on the health benefits of labyrinths. In the analysis of the use of labyrinth walking as a stress & anxiety reduction tool for intern nurses at Mercy Hospital (Oklahoma City, USA) half of the intake were trained in labyrinth walking for relaxation, and the other half as a control group were not. The labyrinth was walked every 90 days over the year. The labyrinth walkers reported a reduced level of job stress across the year and improved job satisfaction level at the years completion.

Staff Benefits

- Tool for reducing stress & anxiety through mindfulness.
- Tool for team building.
- Attain calm & peace before surgery, consultation or meetings.

Patient Benefits

- Labyrinth has the language for addressing emotional & psychological aspects of illness.
- Offers a metaphor for the longer time spans of the treatment journey.
- Intentional walking engages proactive behaviour towards treatment plan.
- The labyrinth is a family & friends friendly space.
- 'Play is the work of children' they immediately 'get' what the pathways of a labyrinth, maze or puzzle are for.

PUBLICATION

NHS Dumfries & Galloway wish to commission a publication which will trace the story of the hospital back to the very first building and the people who worked in it dating from 1872 through the process of the new build to the opening of the new hospital. It is proposed that the publication is image rich and includes oral histories gathered from staff and patients. Material will be published on a website / blog during the build process. This will then be edited and compiled into a publication following the formal opening of the new hospital.

Working with NHS Dumfries & Galloway, Wide Open propose to manage the writing, design and publication process.



Local Artist Jim Buchanan, Finger labyrinth on seat at the edge of a labyrinth.

QUALITY

It is imperative that each phase of each commission is of the highest quality and that the resulting artworks and design solutions reflect the integrity of the architecture and the high quality of healthcare provided.

Creative professionals will be selected whose skills, creativity and ability to engage with user groups and/or communities are appropriate for the commission.

MANAGEMENT AND DELIVERY

The Strategy will be project managed and delivered by Wide Open for the client NHS Dumfries & Galloway.

Committees

All projects will be presented to the Art and Design Committee which will comprise representatives from NHS Dumfries & Galloway and from High Wood Health. The Design Manager NHS Dumfries & Galloway will sign each project element off in accordance with the agreed contract and brief.

Wide Open will consult with a working group comprising key NHS stakeholders.

Commissioning and contractual stages for artists

The majority of artists will be commissioned through an open call and interview. It is proposed however, that due to his unique skills Jim Buchanan will be

commissioned to work closely with the Spiritual Care team, FIRA and identified staff and patient groups to deliver the labyrinths.

Each creative professional will be required to provide enhanced disclosure before commencing work.

Each appointed creative professional will work through three contractual stages, except for the creation of the graphic designs for the screen, signage and desk manifestations. These will be delivered on completion of the design stage.

Completion of each stage to the satisfaction of the Client must be achieved prior to a new contract being issued for the next stage.

- Creative research and development to include indicative costs and time scales;
- Detailed design with costs, time schedules and where appropriate fabricators;
- Implementation and installation.

Costs & funding

The indicative value of the works described is £442,100 excl VAT.

A set allocation of £100,000 is identified for projects agreed with with NHS Dumfries & Galloway and High Wood Health as indicated in Table 2. With match funding identified from allocated build costs and/or from NHS Dumfries & Galloway endowment funds, Wide Open will make fund-raising applications

for the full cost of the delivery of each project from the following funders:

- Area Grants Dumfries & Galloway Council;
- Awards for All;
- Creative Scotland Open Fund;
- Holywood Trust;
- Leader Dumfries & Galloway;
- Moffat Charitable Trust;
- Robertson Trust;
- Wolfson Foundation.

It is proposed that fund-raising commences once the NHS Dumfries & Galloway Board has signed off the strategy. It is proposed that the majority of the fund-raising will be completed for September 2015. It should be noted that deadlines for certain funders fall in the Autumn. These funders have been matched with projects which commence in 2016. All funds raised will be in the name of NHS Dumfries & Galloway Endowments. It is proposed that these funds are ring-fenced within the Endowment accounts.

There may be potential to combine projects as we move through the fund-raising process.

Risks

1. Unable to raise the funds required to deliver the strategy. If this should be the case, the strategy will be adapted following consultation with the Client.
2. Local artists are not available within time scale required or without the skills to

deliver elements of the Strategy. Wide Open will discuss alternative options with the Client.

3. Commissions integral to the building not completed within the agreed time scale. Due to the staged delivery process which each artist is contracted to, it will become apparent early on in their work if the artist is not likely to deliver on time. If this is the case. Their contract will be terminated and a sensible solution agreed between the Client and High Wood Health which does not hold up the build schedule. Very few items are due for completion before building completion and hand over.

Timescale

All works will be completed and installed within the time scales provided by High Wood Health and agreed by the Client.

Evaluation

Funders will require an evaluation. Wide Open will write an evaluation report for each of the funders.

Maintenance

It is understood that NHS Dumfries & Galloway are responsible for maintenance of artworks and design elements for the new hospital and gardens.

Consideration of life cycle costs for each proposed element will be discussed with NHS Dumfries & Galloway as part of the the development of outline proposals.

LEGACY

The work will result in:

- Supporting the creation of a welcoming, friendly and interesting building;
- Enhanced wayfinding;
- Artworks which reflect regional interest and identity, which give the new building
- a strong identity and the hospital community a sense of pride and familiarity;
- Strong long-term partnerships developed with arts, community and voluntary organizations.

6. RESEARCH AND CONSULTATION

Consultations have been undertaken with people in groups and individually.

Community groups and stakeholders

- Arts and Environmental organisations consulted at the 'Thinklab' afternoon and also individually;
- Dumfries & Galloway College staff and students, Dumfries & Stranraer campuses;
- Galloway Community Hospital, Stranraer;
- Dumfries & Galloway Multi Cultural Association;
- Families attending Ward 15 at DGRI;
- Langholm Community Hospital;
- Learning Disabilities group, Castle Douglas;
- Reverend Robin Paisley;

- SANDS Dumfries & Galloway, Alison Hall and Susan Dalglish;
- Scottish Health Council;
- TAG (Dumfries & Galloway Advisory Group meeting for people with learning disabilities). People attended from Dumfries, Annandale and Upper Nithsdale;
- U3A Stranraer.

DGRI staff, patients and volunteers

- Kimberley Baird, Healthcare Support Worker, ICU/HDU;
- Joe Bonner, Porter;
- Kirstin Burns Senior nurse, Acute Children's Ward;
- Dr Heather Currie, Clinical Director of Women and Sexual Health;
- Claire Drummond, Oncology;
- Gladys Haining, Dementia Nurse Consultant;
- Penny Halliday, Dementia Champion, NHS D&G Board;
- Arlene Horsburgh, Senior Charge Nurse, outpatients and Ward 4;
- Dr Ewan Kelly, Spiritual Care Lead NHS Dumfries and Galloway;
- Liz Jardine, Domestic;
- Janette Park, Maintenance Manager, Estates;
- Catriona Thomson, Midwifery in connection with SANDS;
- Anne Westgarth for the Mortuary bereavement suite;
- Nursing, Midwifery and AHP meeting;
- Neonatal staff;
- Oncology staff;
- Oncology patients;

- Paediatrics staff;
- Volunteers, DGRI.

Note: We attempted to arrange consultation days in Annandale and in the Wigtown/Newton Stewart area, but was not able to find the required support to facilitate contact with community/patient groups.

Written sources

A Vision of Health: NHS Scotland's agenda for realising value in the developing healthcare estate, Architecture and Design Scotland 2009.

Dr Heather Delday, (2010), 'An Evaluation. ARTworks, Royal Aberdeen Children's Hospital, 2006 – 2009'.

dignityincare.ca/en/dignity-research.html

dghealth.wordpress.com/2014/07/11/just-another-day-by-heather-currie

www.jameswoodward.info/node?page=12 in relation to Michael Wilson's

The Hospital - A Place of Truth, Published in 1971

Jenny Roe, 'The Restorative Power of Natural and Built Environments', Heriot-Watt University School of Built Environment, 2008.

www.nhsdg.scot.nhs.uk/Departments_and_Services/Putting_You_First/Putting_You_First

Rosalia L. Staricoff, (2003) A Study of the Effects of Visual and Performing Arts in Health Care, Chelsea and Westminster Hospital.

"The Stirling standards for dementia-friendly design", 30.04. 2012

dementia.stir.ac.uk/system/files/filedepot/12/dsdcthe_stirling_

[standards_for_dementia_120430_1.pdf](#)

R. S. Ulrich. "Designing for Calm", New York Times, January 11, 2013.

Building a Space for Calm - NYTimes.com

www.nytimes.com/2013/01/13/opinion/sunday/building-a-space-for-calm.html?_r=1&

Sarah Waller et al, (2008) Improving Environments for Care at End of Life,

<https://www.kingsfund.org.uk/sites/files/kf/Improving-Environments-for-Care-at-End-of-Life-eight-UK-pilot-sites-Waller-Dewar-Masterson-Finn-Kings-Fund-April-2008.pdf>

April-2008.pdf

A. C. Yang, (2003). Walking the labyrinth: A tool of stress reduction for nurses.

Journal of Gynecologic Oncology Nursing 13(3): 18-22.

APPENDICES

Please see separate sheets for:

1. Framework
2. Delivery Schedule